

**Petersburg Borough, Petersburg, Alaska
RESOLUTION #2017-05**

**A RESOLUTION AUTHORIZING AND DIRECTING
THE MUNICIPAL LAND SELECTION AGENT TO TRANSMIT TO
THE ALASKA DEPARTMENT OF NATURAL RESOURCES A PORTION OF
THE BOROUGH'S NOMINATION OF MUNICIPAL ENTITLEMENT LANDS.**

WHEREAS, the Petersburg Borough concurs with the objectives of the Municipal Land Entitlement Act and has actively participated in the nomination of lands under this program; and

WHEREAS, the decision of the Local Boundary Commission concerning the legal boundaries of the Petersburg Borough was confirmed on December 4, 2015 in *City and Borough of Juneau v. Local Boundary Commission and Petersburg Borough*; and

WHEREAS, the Petersburg Borough's Municipal Land Selection Committee evaluated maps, local knowledge, and other data pertaining to all lands under consideration; and

WHEREAS, the Land Selection Committee adopted a set of criteria and used these as a guide in making their recommendations; and

WHEREAS, the Land Selection Committee held public meetings on January 11, February 2, March 7, 2016, and February 28, 2017 to review and comment on recommendations for selection; and

WHEREAS, the Petersburg Borough has been granted an initial entitlement of 1,374 acres of state land, which was later amended to 1,438.53 acres; and

WHEREAS, the Petersburg Borough already submitted land selections totaling approximately 1,225.33 acres and is now nominating an additional 511.28 acres.

THEREFORE BE IT RESOLVED, the Petersburg Borough Assembly approves the document consisting of text and maps entitled "Nominations of Municipal Entitlement Lands (part 2), Petersburg Borough, March 6, 2017" and authorizes and directs the Municipal Land Selection Agent to transmit such nominations as approved by this resolution to the Alaska Department of Natural Resources.

Passed and Approved by the Petersburg Borough Assembly on March 6, 2017.

Mark Jensen, Mayor

ATTEST:

Debra Thompson, Clerk

Nominations of Municipal Entitlement Lands (part 2)
Petersburg Borough
March 6, 2017

Map	Name	Approx. Acres	Legal Description
2	Thomas Bay Alaska Subdivision	11.63	Lots 1,2,3,4 and 5; Block 1, Thomas Bay Subdivision, Plat #82-16 (ASLS 810235)
6	Falls Creek	320	S1/2N1/2, N1/2S1/2, Section 12, T60S, R79E, (portion of P-14)
7	Frederick Pt. East	174.65	Lots 1,2,3,4 Section 10; Lot 1, Section 3; Lot 4, Section 15; T59S, R80E (portion of P-28)
7	Petersburg (Rock Pit)	5	Section 9 (see map)

Map #2, Thomas Bay Subdivision

Lots 1,2,3,4 and 5; Block 1, Thomas Bay Subdivision, Plat #82-16 (ASLS 810235)

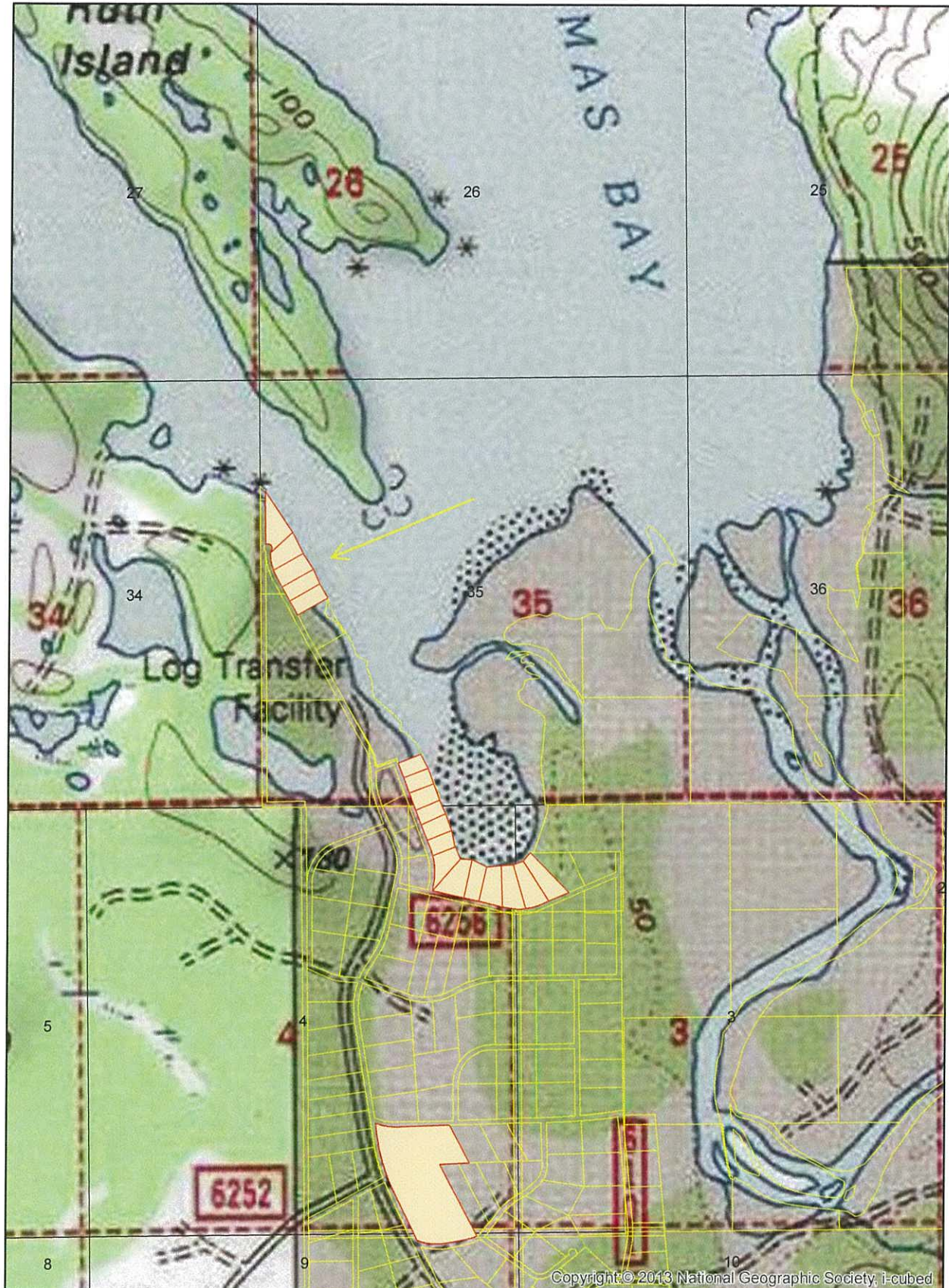

Nomination for Municipal Land Entitlement Petersburg Borough - March 6, 2017

S1/2N1/2, N1/2S1/2, Section 12, T60S, R79E, (portion of P-14)

S1/2N1/2, N1/2S1/2, Section 12, T60S, R79E, (portion of P-14)



Nomination for Municipal Land Entitlement Petersburg Borough - March 6, 2017

Map #7, Frederick Pt. East

Selection: Lots 1,2,3,4, Section 10; Lot 4, Section 15; Lot 1, Section 3

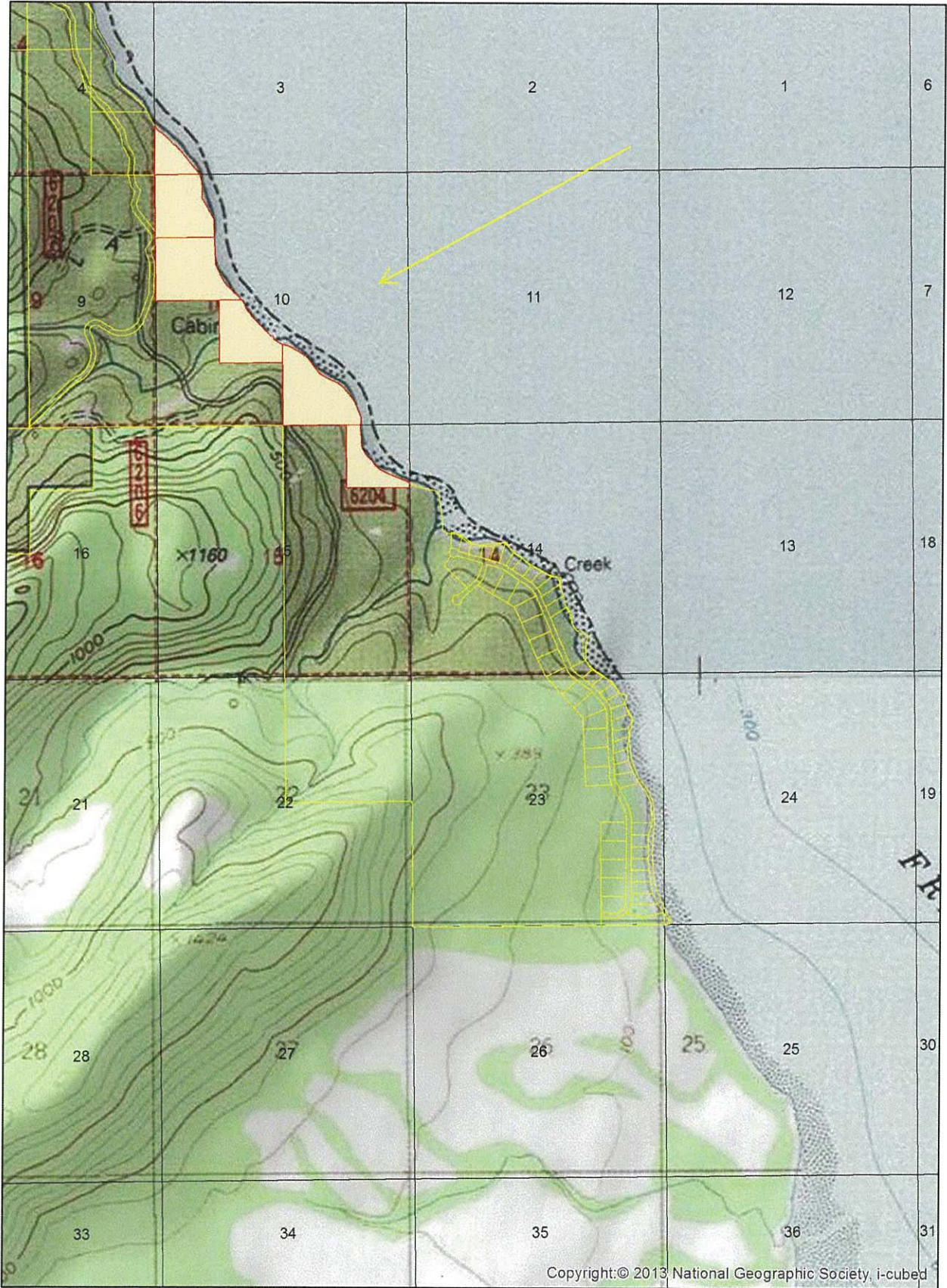

Map #7, Petersburg (Rock Pit)

Portion of E1/2 lying northwest of ASLS 95.66



Nomination for Municipal Land Entitlement Petersburg Borough - March 6, 2017