

PETERSBURG BOROUGH
SPECIAL USE PERMIT
APPLICATION

CODE TO:	110.000.404110
BASE FEE:	\$50.00
PUBLIC NOTICE FEE:	\$70.00
TOTAL:	\$120.00
CHECK NO. or CC:	CK

DATE RECEIVED: **7-20-2020**

RECEIVED BY:

CHECK NO. or CC: **CK**

APPLICANT/AGENT

NAME
Kathy O'Rear
MAILING ADDRESS
PO Box 1309
CITY/STATE/ZIP
Petersburg, AK 99833
PHONE
(907) 772-3332
EMAIL
kathyorear@raincountry.org

LEGAL OWNER (IF DIFFERENT THAN APPLICANT/AGENT)

NAME
N/A
MAILING ADDRESS
N/A
CITY/STATE/ZIP
N/A
PHONE
N/A
EMAIL
N/A

PROPERTY INFORMATION

PHYSICAL ADDRESS or LEGAL DESCRIPTION:
100 Fram Street

PARCEL ID:
01-007-355

ZONE:
Commercial - 1

OVERLAY:

CURRENT USE OF PROPERTY:
Offices and Apartments

LOT SIZE:
10,000 sf

PROPOSED USE OF PROPERTY (IF DIFFERENT):
N/A

SEPTIC SYSTEM: Is there a septic system on the property? ☐ YES ☒ NO

What is current or planned system? ☒ Municipal ☐ DEC-approved on-site system

WATER SOURCE: ☒ Municipal ☐ Cistern/Roof Collection ☐ Well

LEGAL ACCESS TO LOT(S) (Street Name):
Fram Street

TYPE OF APPLICATION

☒ Use of Borough Right-of-Way. Please submit site plan showing area you will be developing/using.

☐ Other:

SUBMITTALS:

Please submit additional information as required for specific permit. See specific application for more information.

SIGNATURE(S):

I hereby affirm all of the information submitted with this application is true and correct to the best of my knowledge. I also affirm that I am the true and legal property owner or authorized agent thereof for the property subject herein.

Applicant(s):
Kathy O'Rear, Finance Officer/Agent

Date: **7/20/2020**

Owner(s):

Date:

19.76 SPECIAL USE APPLICATION

(SUBMIT WITH SITE PLAN)

Applicant(s): Petersburg Mental Health LLC

Address or PID: 100 Fram Street

Project Summary: This project consist of residing the existing building, replacing one set of stairs and revising the layout of the other stairs and a ramp.

Conditions of approval as required in Petersburg Municipal Code 19.76.020:

(Note that all regulations and requirements of Title 19 must be satisfied in order to qualify for a conditional use permit.)

1. The Borough Assembly may issue the permit if the request, as approved by the Planning Commission, is found to be of beneficial nature to the community and that adjacent and surrounding property will not be adversely impacted.

There are instances when the private sector needs to use borough property for uses other than what the property was initially intended for. An example would be to use a platted, but undeveloped, right-of-way for private access to private property.

Explain how your application meets these conditions:

1. The current stair layout goes over the property lines onto the adjacent Salvation Army property. Our new layout will make it so that the stairs will be contained to the Petersburg Mental Health Property.

2. The current ramp already goes into the right of way. Our new ramp layout will reduce that dimension by about 5' - 5".

We believe that both of these instances are beneficial to all parties involved.

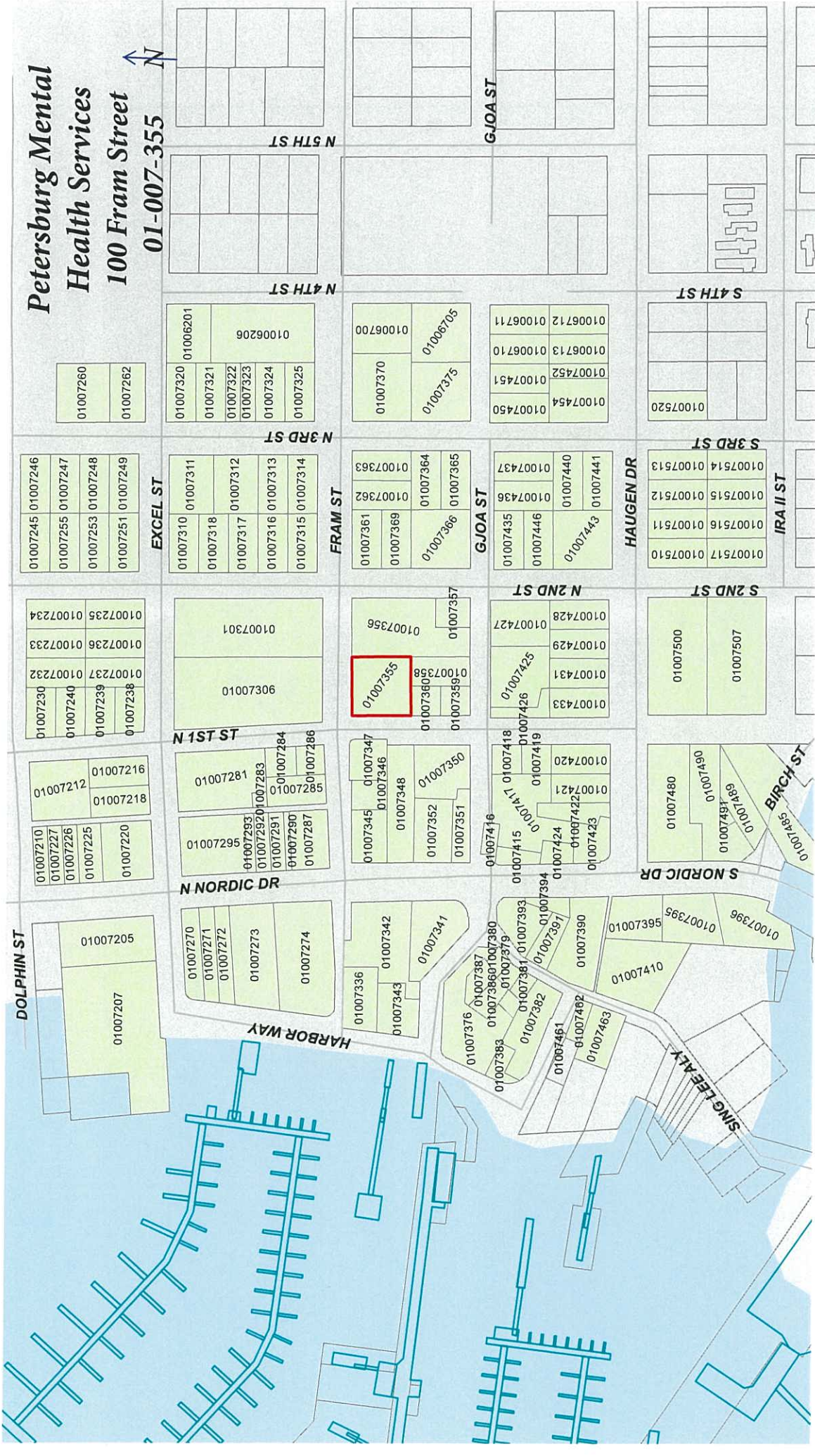

**Petersburg Mental
Health Services
100 Fram Street
01-007-355**

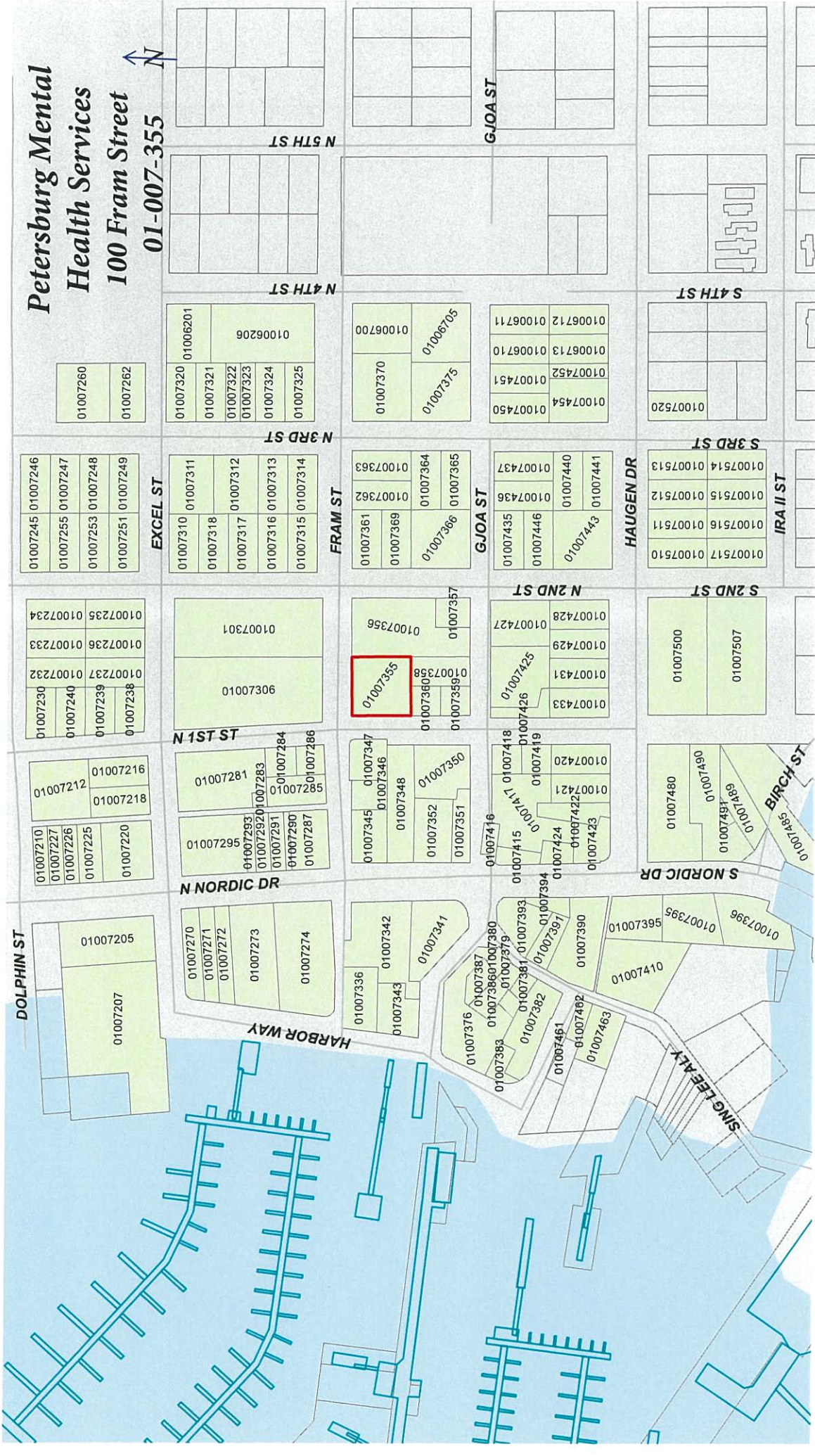

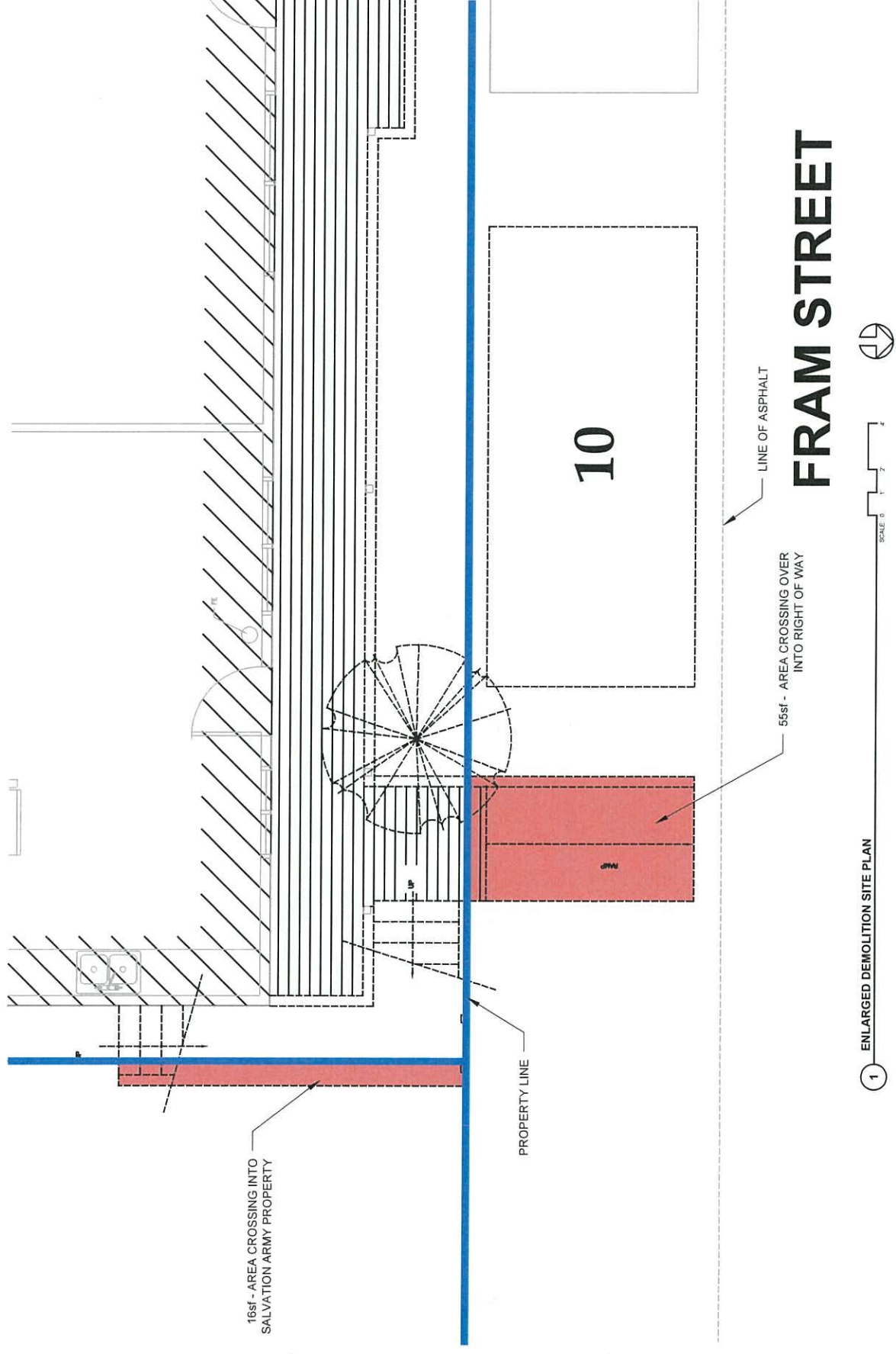

SCALE: 0 1 2 4

1 ENLARGED DEMOLITION SITE PLAN

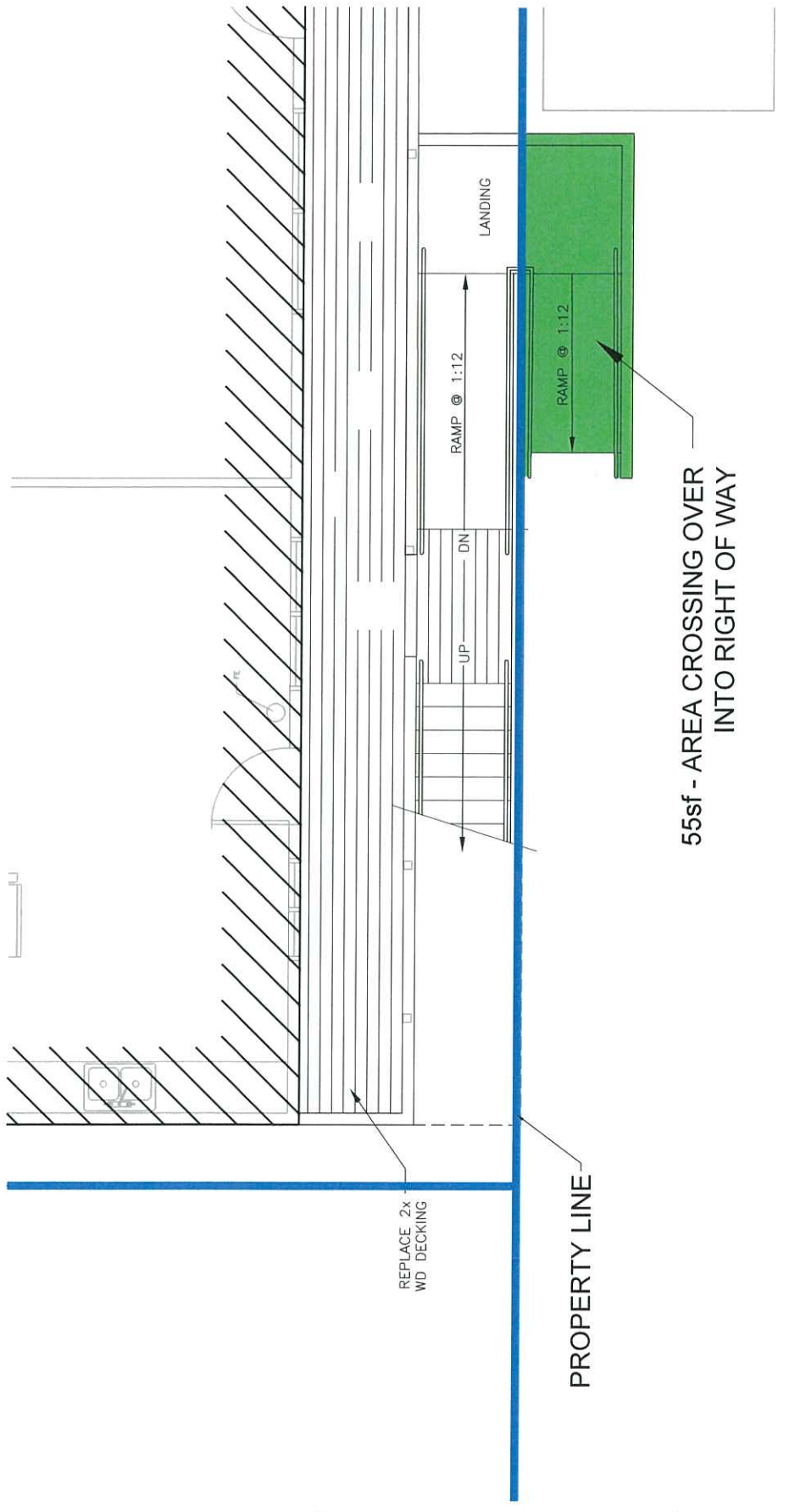

FRAM STREET



SCALE 6' 1" 2' 3'

1 ENLARGED RENOVATION SITE PLAN

LINE OF ASPHALT

PROPERTY LINE

55sf - AREA CROSSING OVER
INTO RIGHT OF WAY

REPLACE 2x
WD DECKING

LANDING

RAMP @ 1:12

UP

DN

RAMP @ 1:12

Debra Thompson

From: Liz Cabrera
Sent: Wednesday, September 16, 2020 3:18 PM
To: Debra Thompson
Subject: FW: SUP for Mental Health Services

FYI

From: Chris Cotta <ccotta@petersburgak.gov>
Sent: Wednesday, September 16, 2020 3:10 PM
To: Liz Cabrera <lcabrera@petersburgak.gov>
Cc: Joe Bertagnoli <jbortagnoli@petersburgak.gov>
Subject: RE: SUP for Mental Health Services

No comments, other than we have no objections to the proposed work. Thanks,

Chris

From: Liz Cabrera <lcabrera@petersburgak.gov>
Sent: Wednesday, September 16, 2020 11:06 AM
To: Chris Cotta <ccotta@petersburgak.gov>
Cc: Joe Bertagnoli <jbortagnoli@petersburgak.gov>
Subject: RE: SUP for Mental Health Services

Chris,

I'm submitting this to the Assembly for consideration – any comments?

Liz

From: Liz Cabrera
Sent: Thursday, September 10, 2020 1:20 PM
To: Karl Hagerman <khagerman@petersburgak.gov>; Chris Cotta <ccotta@petersburgak.gov>
Cc: Joe Bertagnoli <jbortagnoli@petersburgak.gov>
Subject: SUP for Mental Health Services

Karl/Chris,

The Commission is recommending approval to the attached request.

Please let me know if you have any comments and I will include them in the report to the Assembly.

Thx,
Liz

Liz Cabrera
Community Development
Petersburg Borough
PO Box 329